

Assembled for RG-100 / RG-200

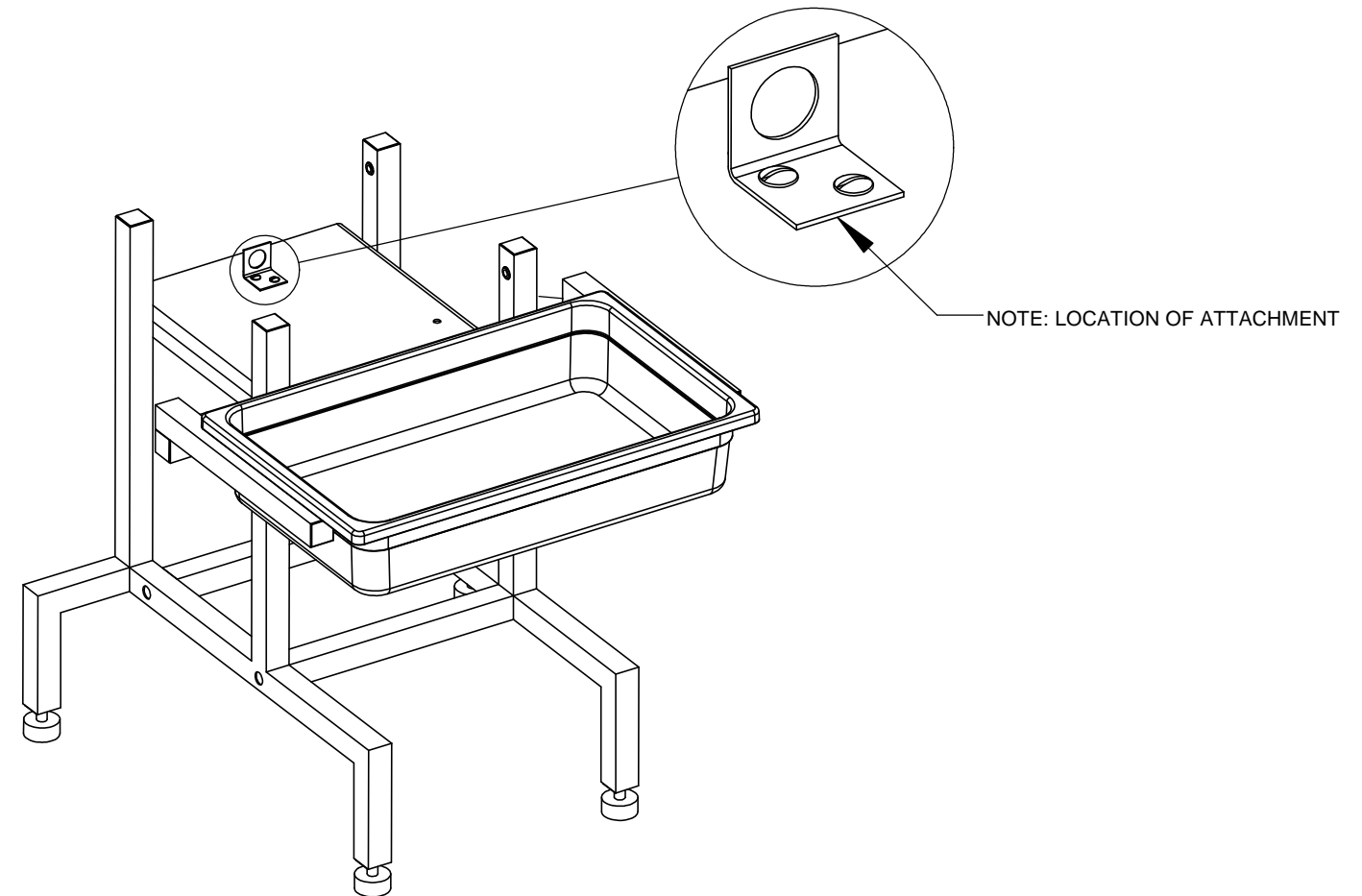

Assembled for RG-250 / RG-300 / RG-350

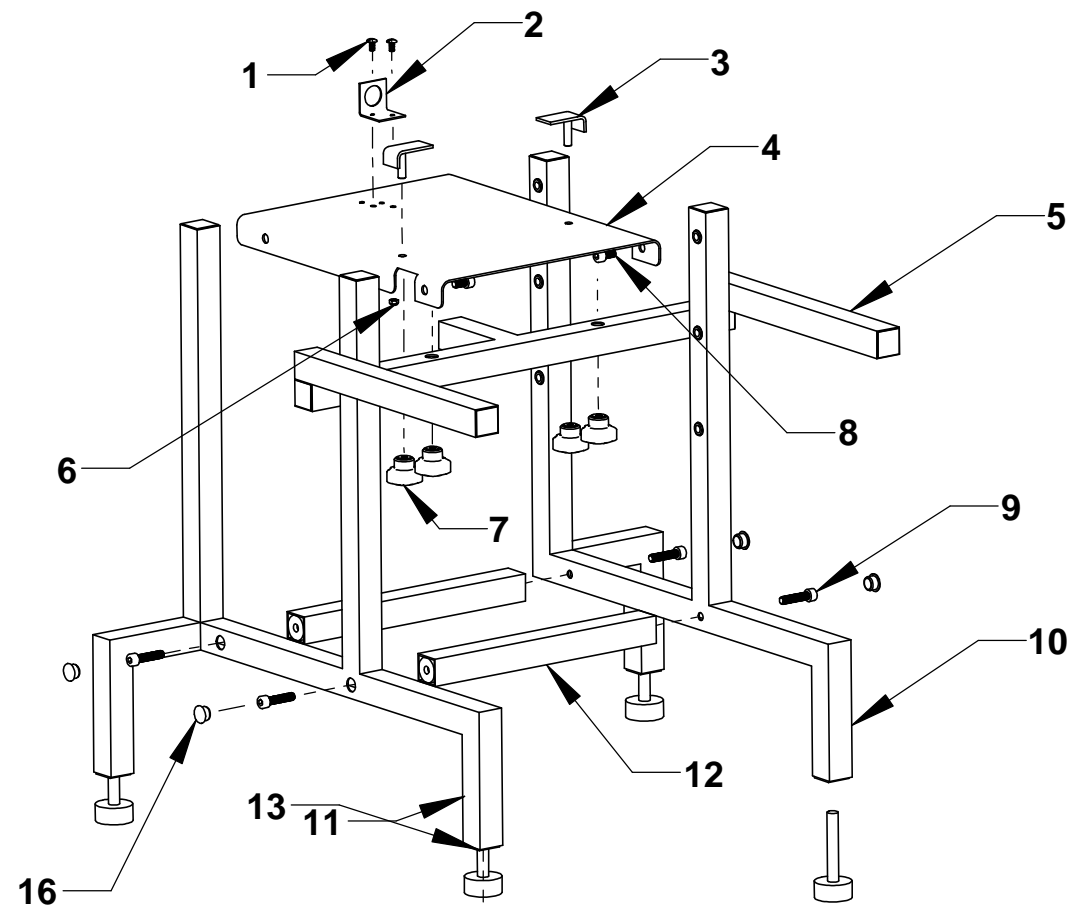

- | | | | |
|--|----|----------------------|------|
| | 1 | Din 985 Lsks M5 x 10 | 2pcs |
| | 2 | Bracket | 1pcs |
| | 3 | Clamp | 2pcs |
| | 4 | Plate | 1pcs |
| | 5 | Cantine Holder | 1pcs |
| | 6 | Lock-Nut M5 Din 985 | 2pcs |
| | 7 | Nut With Handle | 4pcs |
| | 8 | Mc6s M8 x 15 | 4pcs |
| | 9 | Mc6s M8 x 35 | 4pcs |
| | 10 | Side Left | 1pcs |
| | 11 | Side Right | 1pcs |
| | 12 | Distance | 2pcs |
| | 13 | Table Foot | 4pcs |
| | 14 | Cantine | 1pcs |
| | 15 | Allen Key 6 mm | 1pcs |
| | 16 | Plug | 4pcs |

HALLDE

MACHINE TABLE FOR
RG-100 / RG-200 / RG-250
RG-300 / RG-350 / RG-7

Ritad av Dwn by	WE	Rev.dat. Rev.date	
Godk. Appr.	WE	Dat. Date	06-01-11
Ritn.nr Drawing no.	1234		