

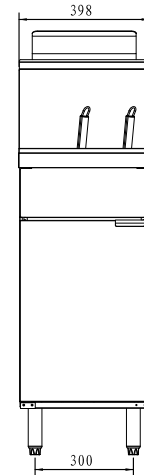

V PAN PASTA AND NOODLE COOKER

- Stainless steel front and sides
- 34 litre tank capacity
- Standby Stainless steel pilot for easy start
- 6 inch stainless steel leg
- Millivolt control valve
- Prompt response thermostat ensures fast temperature recovery and accurate temperature control
- One 1/4" full port drain valve
- Open pot design features easy cleaning
- Stainless steel hanger plate at the back
- Ø 125mm x 132mm Baskets
- 1/2 inch NPT rear gas connection
- Front positioned water inlet
- Water purifying overflow system to remove excess starch

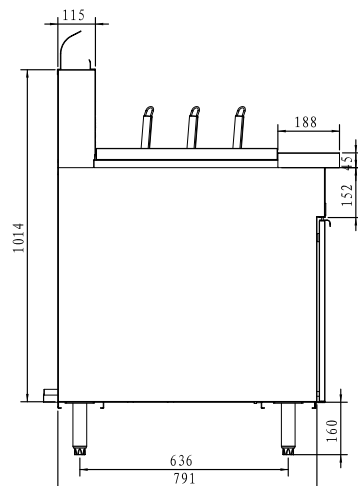
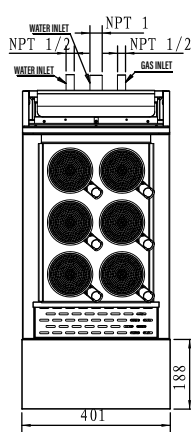
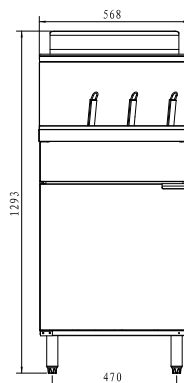
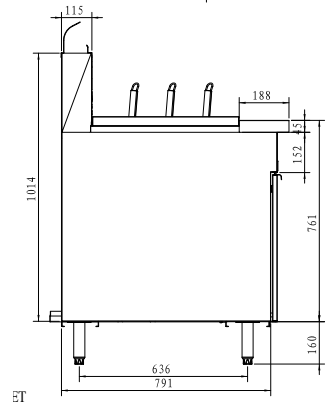
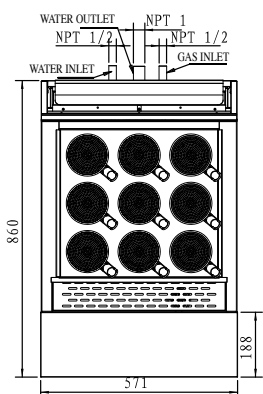

Code	Gas Type	Baskets	Capacity (L)	Dimensions (WxDxH mm)	Weight (kg)	Regulator Size	Consumption (MJ/h)
PC150-9	NG	9	34	571x860X1293	101	1/2"	150
PC150-9LPG	LPG	9	34	571x860X1293	101	1/2"	190
PC150-6	NG	6	27	401x860x1293	78	1/2"	150
PC150-6LPG	LPG	6	27	401x860x1293	78	1/2"	190

Code	Description
------	-------------

Accessories

302110331	Pasta / Noodle Basket
RC400T-18	Adjustable Leg

• Gas equipment must be commissioned by an authorised technician.
 Prices and specifications are subject to change without notice. Pictures are for illustrative purpose and final product may differ