

650 SERIES EQUIPMENT



Example of optional bench stand
shown on FlexiDrawer Counter
Fridges CRB1-2 + CRB1-3

• Gas equipment must be commissioned by an authorised technician.
Prices and specifications are subject to change without notice. Pictures are for illustrative purpose and final product may differ

650 SERIES -CHARGRILL/CHARGRILL GRIDDLE COMBO



- Stainless steel construction
- Compact design
- Italian gas valve
- Sturdy adjustable feet
- Food van friendly
- Heavy duty cast iron chargrill



JUS-TRH40/JUS-TRH40LPG

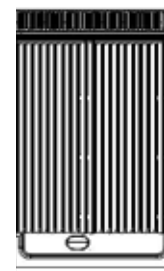
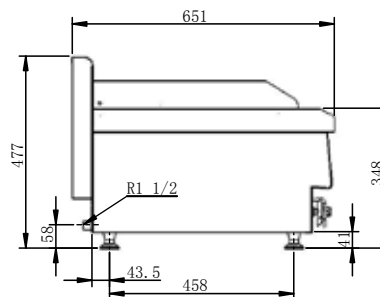
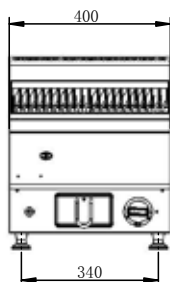

JUS-TRH60/JUS-TRH60LPG

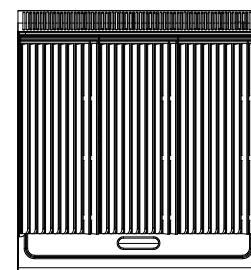
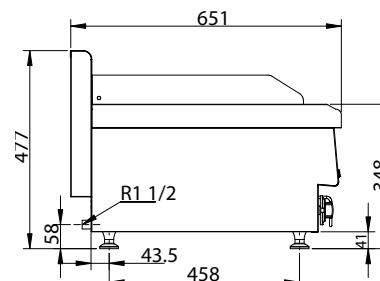
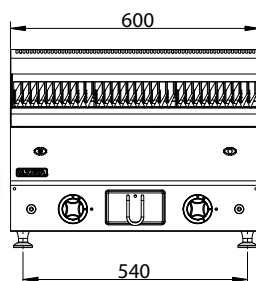

JUS-TRGH60/JUS-TRGH60LPG

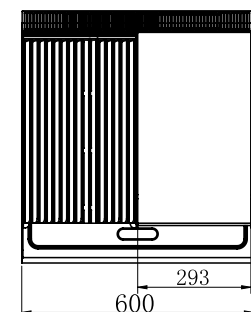
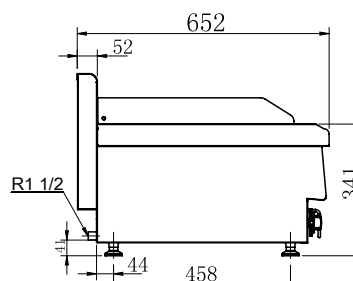
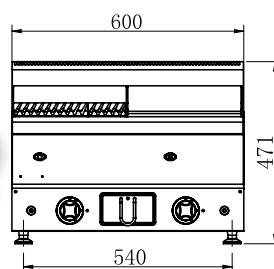

Code	Gas Type	Dimensions (WxDxH mm)	Weight (kg)	Regulator Size	Consumption (MJ/h)
1 Burner Chargrill					
JUS-TRH40	NG	400x650x475+60	45	1/2"	28
JUS-TRH40LPG	LPG	400x650x475+60	45	1/2"	28
2 Burner Chargrill					
JUS-TRH60	NG	600x650x475+60	73	1/2"	56
JUS-TRH60LPG	LPG	600x650x475+60	73	1/2"	56
2 Burner 1/2 Chargrill & 1/2 Griddle					
JUS-TRGH60	NG	600x650x475+60	77	1/2"	49
JUS-TRGH60LPG	LPG	600x650x475+60	77	1/2"	49

• Gas equipment must be commissioned by an authorised technician.

Prices and specifications are subject to change without notice. Pictures are for illustrative purpose and final product may differ