

REFRIGERATED WASTE COOLERS

- CFC free refrigerant and foam
- Insulation 40mm thickness
- Auto defrosting and auto evaporation of condensation water
- Electronic thermostat and digital LED temperature display for accurate control and easy reading
- Self-closing door
- Magnetic gasket can be replaced without any tool
- Designed to accommodate 240 litre dustbin
- Monoblock unit

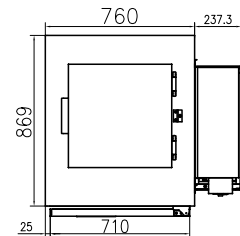

WBC1-240

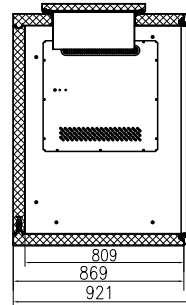
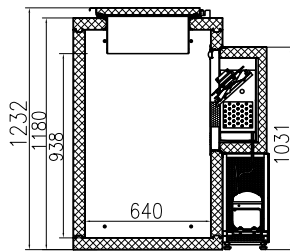

WBC2-240

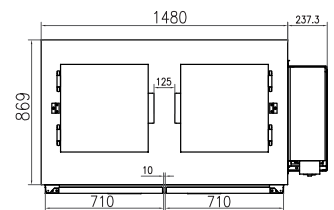
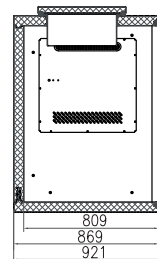
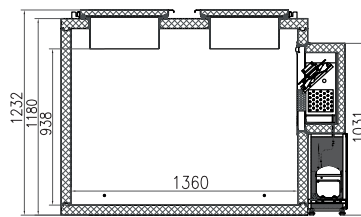

Code	Litre	Dimensions (WxDxH mm)	Weight (kg)	Temperature Range	Ambient/ RH%	Voltage	Power (W/A)
WBC1-240	1x240	1090x920x1230	121	+2 to +8	32/55	240	315/10
WBC2-240	2x240	1810x920x1230	155	+2 to +8	32/55	240	320/10

Allow 100mm clearance for installation, all vents must be left clear.
Prices and specifications are subject to change without notice. Pictures are for illustrative purpose and final product may differ