

650 SERIES EQUIPMENT



Example of optional bench stand
shown on FlexiDrawer Counter
Fridges CRB1-2 + CRB1-3

• Gas equipment must be commissioned by an authorised technician.
Prices and specifications are subject to change without notice. Pictures are for illustrative purpose and final product may differ

650 SERIES -GRIDDLE PLATE

- Stainless steel construction
- Sturdy adjustable feet
- Compact design
- Food van friendly
- Italian gas valve
- 12mm mild steel griddle plate
- Optional stand

JUS-TRG40/JUS-TRG40LPG

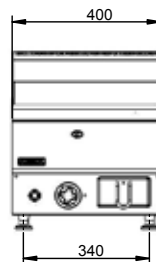

JUS-TRG60/JUS-TRG60LPG

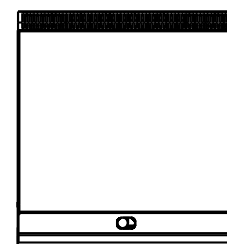
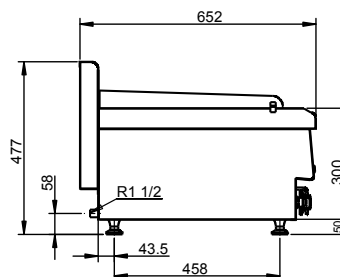
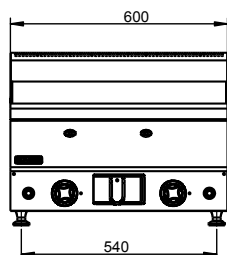

Code	Gas Type	Burner	Dimensions (WxDxH mm)	Weight (kg)	Regulator Size	Consumption (MJ/h)
JUS-TRG40	NG	1	400x650x475	47	1/2"	21
JUS-TRG40LPG	LPG	1	400x650x475	47	1/2"	21
JUS-TRG60	NG	2	600x650x475	67	1/2"	42
JUS-TRG60LPG	LPG	2	600x650x475	67	1/2"	42

650 SERIES COUNTERTOP GAS FRYER

- Stainless steel construction
- Compact design
- Italian gas valve
- Sturdy adjustable feet
- Food van friendly
- Optional stand
- Front mounted drain for easy cleaning and maintenance



JUS-TRC-1

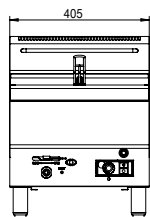
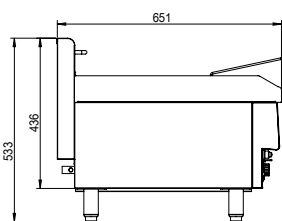

JUS-TRC-2

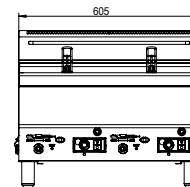
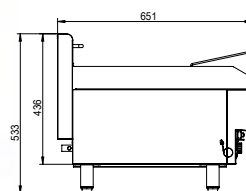

Code	Gas Type	Tank Capacity (L)	Dimensions (WxDxH mm)	Weight (kg)	Regulator Size	Consumption (MJ/h)
JUS-TRC-1	NG	10	400x650x475	23	1/2"	15
JUS-TRC-1LPG	LPG	10	400x650x475	23	1/2"	14
JUS-TRC-2	NG	2 x 10	600x650x475	38	1/2"	33
JUS-TRC-2LPG	LPG	2 x 10	600x650x475	38	1/2"	33

• Gas equipment must be commissioned by an authorised technician.

Prices and specifications are subject to change without notice. Pictures are for illustrative purpose and final product may differ