

SUPERMARKET COMBINED FREEZER

- R290 natural refrigerant
- Reduce floor footprint
- Easy to operate
- Electronic digital temperature control / display
- Quick and easy installation
- Boost product display advertising
- Streamlined operation
- LED lighting
- Auto-Defrost

TOP FREEZER

- Stainless steel inner bottom
- Easy to maintain
- Illuminated top canopy for advertising
- Triple glazed self-closing glass door with heat film
- Hinged self closing doors
- Fan cooling

BOTTOM FREEZER

- Low-E, tempered glass
- Sliding doors
- Equipped with storage mesh or full baskets
- Adjustable feet
- Static cooling system with auto defrost
- Optional manual defrosting models available on request. Ideal for ice cream storage



ZCD-TD125



ZCD-TD145



ZCD-TD210

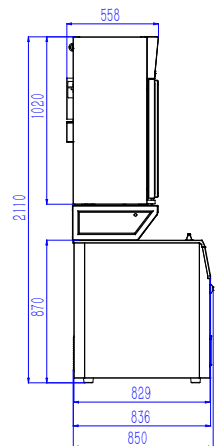
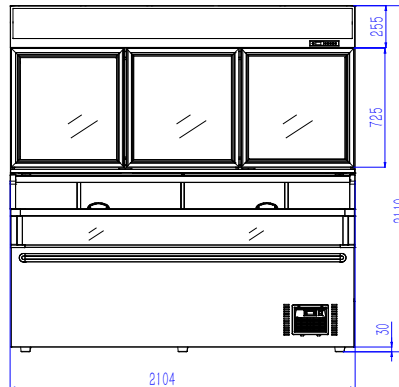
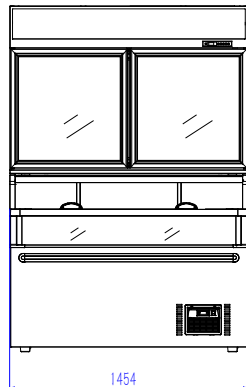
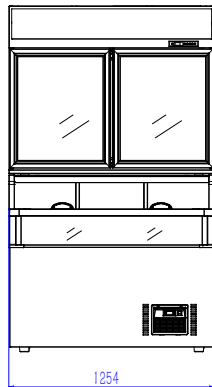

Code	Freezer	Litre	Door	Shelves	Dimensions (WxDxH mm)	Weight (kg)	Temperature Range	Ambient/ RH%	Voltage	Power (W/A)
ZCD-TD125	Top	316	2	4	1250x590x1022	122	-22 to -18	25/60	240	550/10
	Bottom	470	2	-	1252x836x870+210	111	-22 to -18	25/60	240	320/10
ZCD-TD145	Top	373	2	4	1450x590x1022	122	-22 to -18	25/60	240	741/10
	Bottom	575	2	-	1454x850x870+210	121	-22 to -18	25/60	240	727/10
ZCD-TD210	Top	559	3	6	2104x590x1022	188	-22 to -18	25/60	240	920/15
	Bottom	900	3	-	2104x850x870+210	158	-22 to -18	25/60	240	721/10

Allow 100mm clearance for installation, all vents must be left clear. Prices and specifications are subject to change without notice. Pictures are for illustrative purpose and final product may differ