

SUC/SUF TROPICALISED S/S UPRIGHT FRIDGES & FREEZERS

HEAVY DUTY lockable units with factory balanced system which improves temperature recovery times, cools the cabinet quicker keeping food fresher for longer & lowering running costs.

1/2 SPLIT DOORS LOWER YEARLY RUNNING COST BY 1/3

- Embraco compressors & German ËBM-Pabst fans
- Patterned design digital temp. controller & read-out
- 4 levels of shelving plus floor
- Fan-forced evaporator cooling
- Auto defrost
- Self evaporating drainage
- Insulation is CFC & HCFC free
- Self-closing doors with locks
- Internal corners are constructed for easy cleaning
- Refrigerated +2°C to +5°C Ambient 43°C & 40% RH
- Freezer -22 to -18°C Ambient 38°C & 50% RH
- Castors

NEW upgraded touch pad controller

SUC500 / SUF500

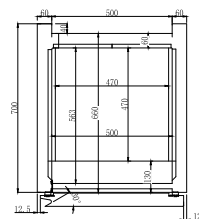
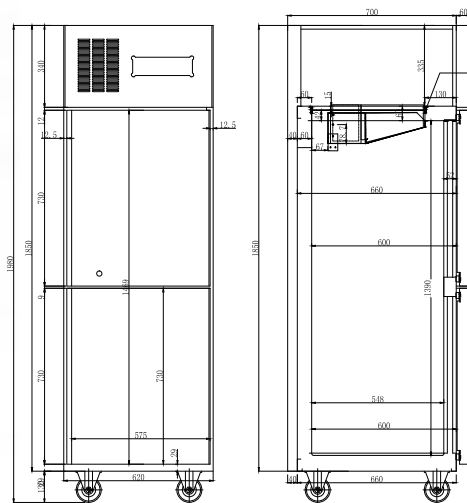

**FRIDGE
AMBIENT 43°C**

**FREEZER
AMBIENT 38°C**

SUC1000 / SUF1000

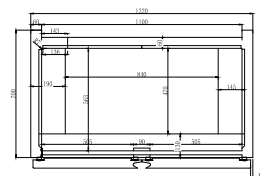
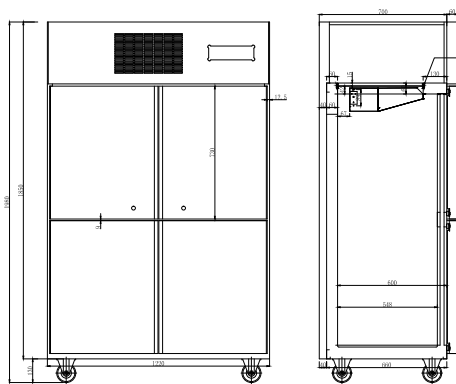

Code	Litre	Dimensions (WxDxH mm)	Weight (kg)	Temperature Range	Ambient/ RH%	Voltage	Power (W/A)
2x 1/2 door fridges							
SUC500	500	620x760x1980	115	+2 to +5	43/40	240	256/10
2x 1/2 door freezer							
SUF500	500	620x760x1980	115	-22 to -18	38/50	240	497/10
4x 1/2 door fridges							
SUC1000	1000	1220x760x1980	182	+2 to +5	43/40	240	678/10
4x 1/2 door freezer							
SUF1000	1000	1220x760x1980	182	-22 to -18	38/50	240	807/10

Allow 100mm clearance for installation, all vents must be left clear. Prices and specifications are subject to change without notice. Pictures are for illustrative purpose and final product may differ