

# TPP-AT-67D-4-HC

 Pizza Prep Table, 9x 1/3 Top Pans, 4 Drawers



| Dimensions                         |  | Build                 |   | Technical                   |                    |
|------------------------------------|--|-----------------------|---|-----------------------------|--------------------|
| External Width (mm)                | 1709   | Number of Drawers     | 4   | Temperature Holding         | 0.5 : 5°C          |
| External Depth (mm)                | 854  | Exterior Construction | Stainless steel front, top & lids, aluminium sides and rear | Refrigerant                 | R290               |
| External Height (mm)               | 1133   | Interior Construction | Clear coated aluminium, stainless steel base                | Voltage / Frequency / Phase | 220-240V/50-60Hz/1 |
| Exclusions                         | Depth does not include 26 mm for rear bumpers and 42mm for cutting board overhang. | Air Intake Position   | Front   | Amps                        | 1.8                |
| Gross Volume (Litres)              | 583  | Ventilation Position  | Front   | Wattage                     | 414                |
| Top Pans Supplied (max depth mm)   | 9x 1/3 GN (150)  | Clearance Required    | Zero back and sides   | Defrost Type                | Auto               |
| Per Drawer Capacity (max depth mm) | 1x 2/1 GN (200)  | Cord Length (Meters)  | 3.35  |                             |                    |
| Unpackaged Weight (kg)             | 196  | Standard w/ Locks     | Not standard (SPEC3 option)                                 |                             |                    |
| Packaged Weight (kg)               | 207  |                       |   |                             |                    |
| Packaged Dimensions (W x D x H mm) | 1880 x 966 x 1245  |                       |   |                             |                    |
| Cutting Board (L x D mm)           | 1709 x 496   |                       |   |                             |                    |
| Supplied Supports                  | ø 127 mm castors (146 mm height)   |                       |   |                             |                    |



Specifications subject to change without notice.  
 Technical data above related to energy use based on testing of 50Hz or Dual Frequency models  
 Chart dimensions rounded up to the next whole millimeter (inches rounded up to the 1/8")

UK & Ireland [0800 783 2049](tel:08007832049)  
 EMEA [+41 61 563 07 05](tel:+41615630705)  
 Australia [+61 2 9619 9999](tel:+61296199999)

[TFIUK@truemfg.com](mailto:TFIUK@truemfg.com)  
[TrueCHCustomerService@truemfg.com](mailto:TrueCHCustomerService@truemfg.com)  
[TrueRefAus@truemfg.com](mailto:TrueRefAus@truemfg.com)



# TPP-AT-67D-4-HC

 Pizza Prep Table, 9x 1/3 Top Pans, 4 Drawers

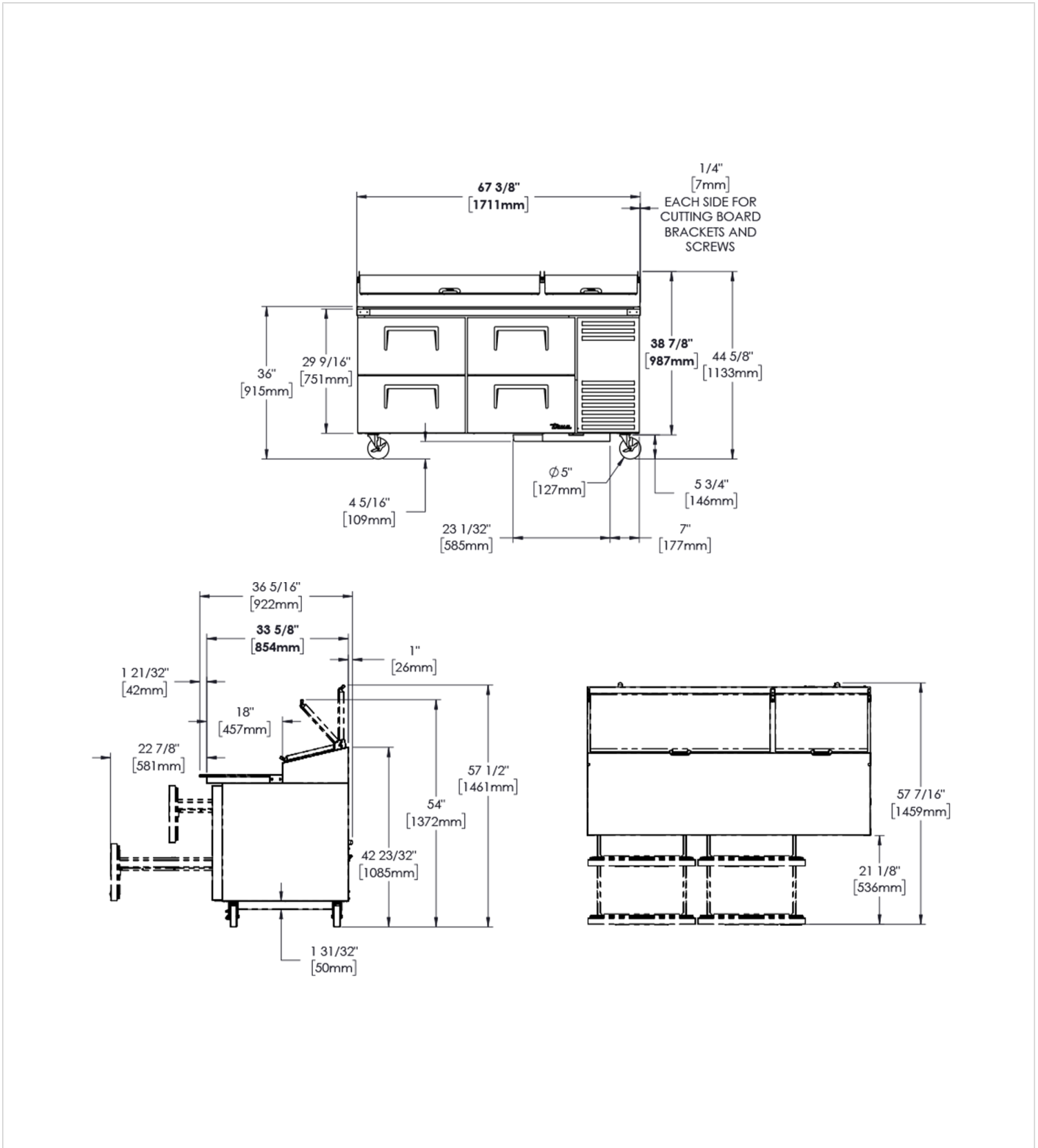

**WARRANTY** 5 YEARS  
PARTS, COMPRESSOR AND LABOUR  
 natural refrigerant.

Specifications subject to change without notice.  
Technical data above related to energy use based on testing of 50Hz or Dual Frequency models  
Chart dimensions rounded up to the next whole millimeter (inches rounded up to the 1/8")

UK & Ireland [0800 783 2049](tel:08007832049)  
EMEA [+41 61 563 07 05](tel:+41615630705)  
Australia [+61 2 9619 9999](tel:+61296199999)

[TFIUK@truemfg.com](mailto:TFIUK@truemfg.com)  
[TrueCHCustomerService@truemfg.com](mailto:TrueCHCustomerService@truemfg.com)  
[TrueRefAus@truemfg.com](mailto:TrueRefAus@truemfg.com)

