

GC301 PLUS

40 x 1/1GN roll in blast chiller/freezer (pass through)

functions

Blast chilling cycles +3°C HARD/SOFT

Blast freezing cycles -18°C HARD/SOFT

Thawing

Retarder proofer

Low temperature cooking

Max. chilling capacity (+3°C) / kg **400**

Max. freezing capacity (-18°C) / kg **300**

Climatic class **4**

technical data

Width (mm) **1500**

Depth (mm) **2380**

Height (mm) **2300**

Weight (kg) **980**

N° trays 1/1GN (535x325) or 600x400 **40**

N° trays trolleys 1/1GN **2**

Electric connection (V/~ /Hz) **420/3/50
+ N**

Electric power (W) **15000**

Max. absorbed current (A) **24.21**

Compressor (HP) **30**

Refrigerant type (gas) **R452A**

Internal width (mm) **700**

Internal depth (mm) **1780**

Internal height (mm) **2020**

Gross weight (kg) **1140**



main features

- Full Touch 7-inch Display
- Finely “Scotch Brite” brushed exterior
- 80 mm insulation thickness in CFC and HCFC-free PU, density 42 kg/m³
- 2mm stainless steel floor
- Large storage capacity cell featuring rounded corners for easy cleaning
- Ergonomic handles
- Front electric panel that can be fully inspected
- Drain
- Air distribution with new evaporator deflector
- OPTIONAL electronic expansion valve
- PLUS versions ventilation regulation by inverter
- Connectivity 4.0
- Load capacity pursuant to EN17032
- OPTIONAL weather sealed and soundproofed condensing units

401 (C20) "H"

- Ⓢ INGRESSO REFRIGERANTE
REFRIGERANT INLET
- Ⓢ USCITA REFRIGERANTE
REFRIGERANT OUTLET
- Ⓢ CONNESSIONE ELETTRICA
ELECTRICAL CONNECTION
- Ⓢ CONNESSIONE SCARICO
DRAIN CONNECTION
- Ⓢ CONNESSIONE H₂O
WATER CONNECTION
- Ⓢ DIMENSIONI mm
DIMENSIONS [in]

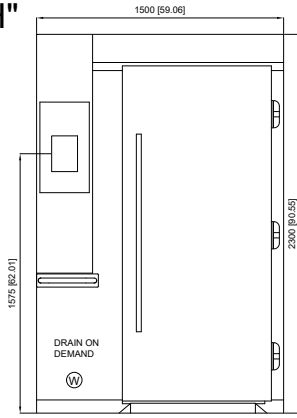

FRONT VIEW

