

## GC151 PLUS

20 x 1/1GN roll in blast chiller/freezer (pass through)

### functions

Blast chilling cycles +3°C HARD/SOFT

Blast freezing cycles -18°C HARD/SOFT

Thawing

Retarder proofer

Low temperature cooking

Max. chilling capacity (+3°C) / kg **200**

Max. freezing capacity (-18°C) / kg **150**

Climatic class **4**

### technical data

Width (mm) **1500**

Depth (mm) **1460**

Height (mm) **2300**

Weight (kg) **490**

N° trays 1/1GN (535x325) or 600x400 **20**

N° trays trolleys 1/1GN **1**

Electric connection (V/~ /Hz) **420/3/50  
+ N**

Electric power (W) **7665**

Max. absorbed current (A) **12.82**

Compressor (HP) **10**

Refrigerant type (gas) **R452A**

Internal width (mm) **700**

Internal depth (mm) **880**

Internal height (mm) **2020**

Gross weight (kg) **570**



### main features

- Full Touch 7-inch Display
- Finely “Scotch Brite” brushed exterior
- 80 mm insulation thickness in CFC and HCFC-free PU, density 42 kg/m<sup>3</sup>
- 2mm stainless steel floor
- Large storage capacity cell featuring rounded corners for easy cleaning
- Ergonomic handles
- Front electric panel that can be fully inspected
- Drain
- Air distribution with new evaporator deflector
- OPTIONAL electronic expansion valve
- PLUS versions ventilation regulation by inverter
- Connectivity 4.0
- Load capacity pursuant to EN17032
- OPTIONAL weather sealed and soundproofed condensing units

**201 (C20) "H"**

- Ⓢ1 INGRESSO REFRIGERANTE  
REFRIGERANT INLET
- Ⓢ2 USCITA REFRIGERANTE  
REFRIGERANT OUTLET
- ⓔ CONNESSIONE ELETTRICA  
ELECTRICAL CONNECTION
- Ⓦ CONNESSIONE SCARICO  
DRAIN CONNECTION
- Ⓜ CONNESSIONE H<sub>2</sub>O  
WATER CONNECTION
- Ⓜ DIMENSIONI mm  
DIMENSIONS [in]

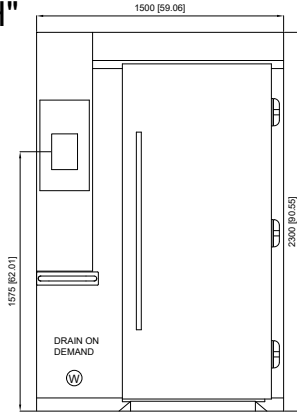

FRONT VIEW

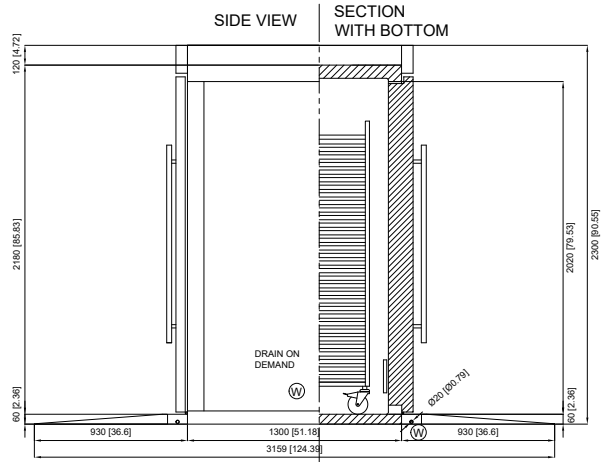

SIDE VIEW

SECTION WITH BOTTOM

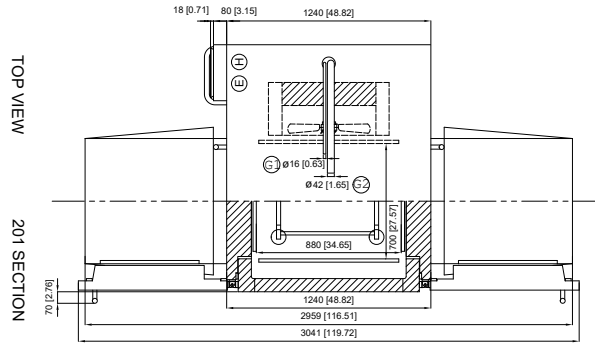

TOP VIEW

201 SECTION